

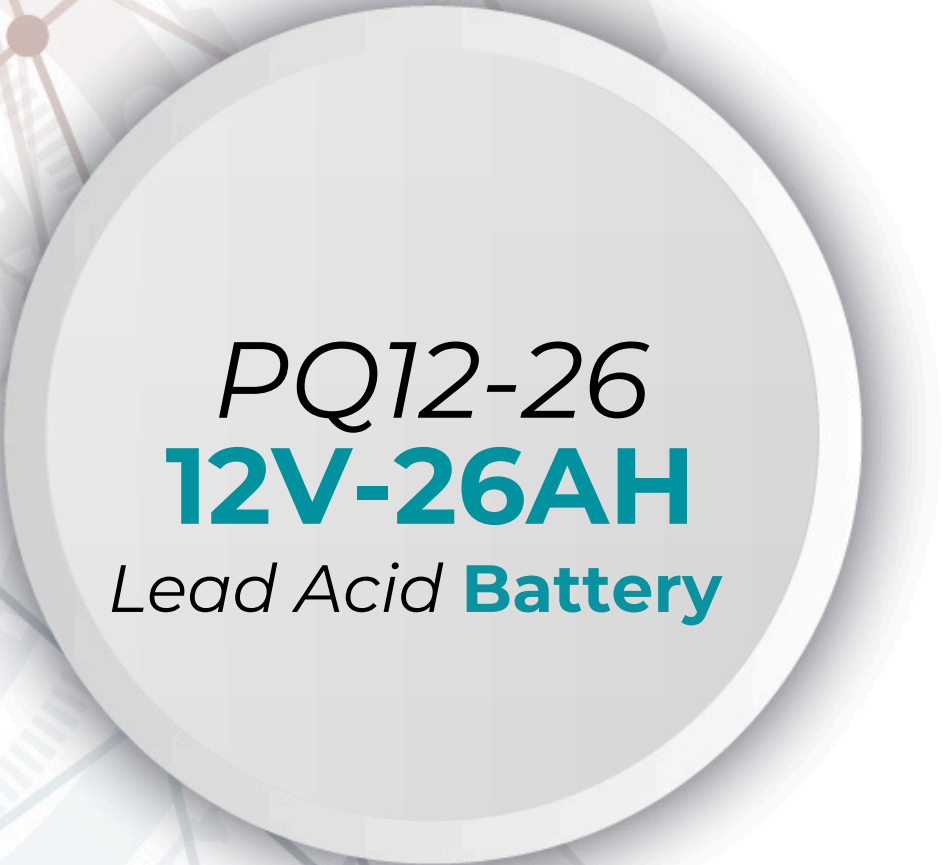

POWERQ
never will be dark



PQ12-26
12V-26AH
Lead Acid Battery



The PQ12-26 is a 12V-26Ah lead-acid battery designed for solar, UPS, and backup power. It delivers reliable performance, long service life, and stable energy storage.

DIMENSIONS

Length (L)	$166 \pm_{-1}^{+2}$ (6.54 $\pm_{-0.04}^{+0.08}$)
Width (W)	$175 \pm_{-1}^{+2}$ (6.89 $\pm_{-0.04}^{+0.08}$)
Height (H)	$125 \pm_{-1}^{+2}$ (4.92 $\pm_{-0.04}^{+0.08}$)
Overall Height (HT)	$125 \pm_{-1}^{+2}$ (4.92 $\pm_{-0.04}^{+0.08}$)

SPECIFICATIONS

(Units: mm (inch))

Nominal Voltage (V)

12v

Nominal Capacity at 25°C (77°F)

20 hour rate	(1.3A to 10.50V)	26Ah
10 hour rate	(2.47A to 10.50V)	24.7Ah
5 hour rate	(4.42A to 10.20V)	22.1Ah
1 C	(26A to 9.60V)	13.87Ah
3C	(78A to 9.60V)	9.1Ah

Weight

Approx. 8.1kg (17.6Lbs.)

Internal Resistance (at 1 KHz)

Approx. 10.0 mΩ

Maximum Discharge Current For

5 seconds: 390A

Charging Methods at 25°C (77°F)

Cycle use:

Maximum Charging Current 7.8A

Standby use:

Float Charging Voltage 13.5 to 13.8V
Coefficient -3.0mV/°C/cell

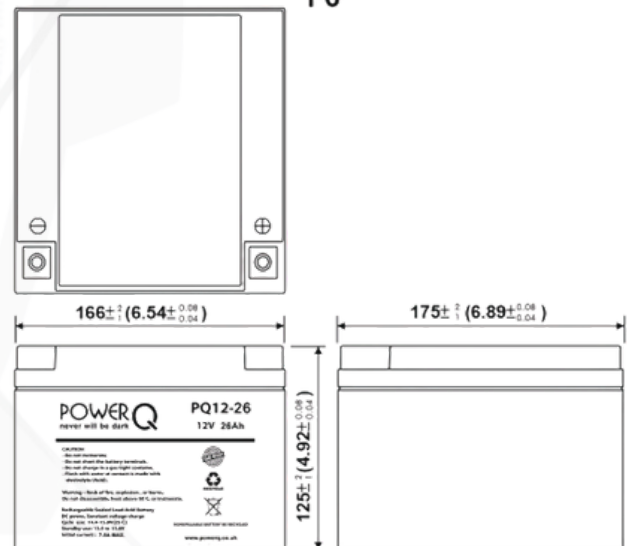
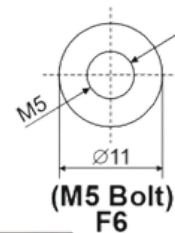

(V) FOR 12V BATTERY Discharge Time VS. Discharge Current (25°C)

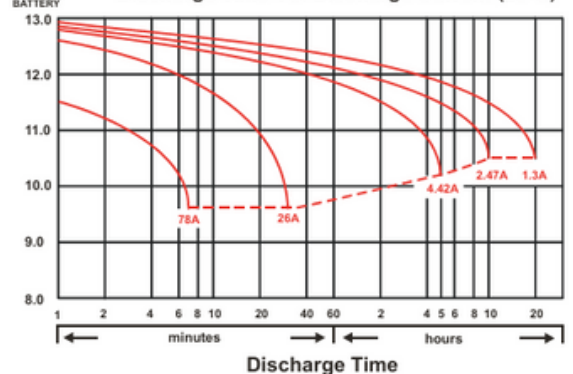

(Units: mm (inch))

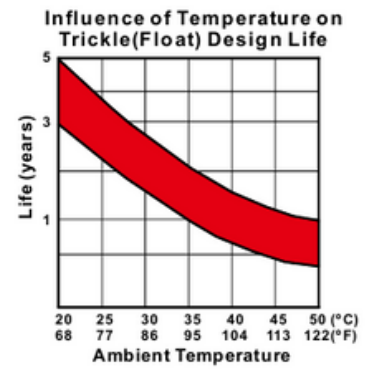
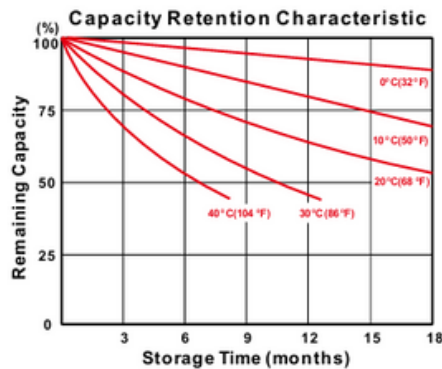
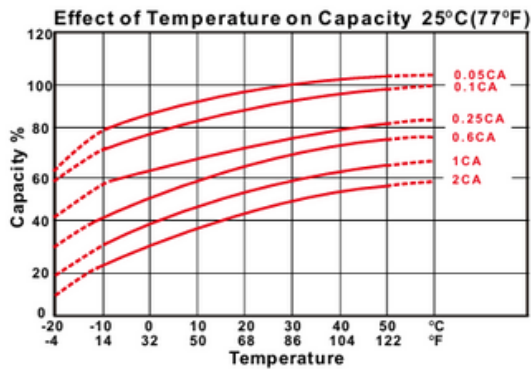

Operating Temperature Range		Case Material	
Charge	-15°C (5°F) to 40°C (104°F)	ABS UL94 HB	
Discharge	-15°C (5°F) to 50°C (122°F)	Optional: Flammability resistance of (UL94-V-0)	
Storage	-15°C (5°F) to 40°C (104°F)	Design Life & Standard	
Charge Retention (Shelf life) (at 20°C (68°F))		EUROBAT (20°C)	
1 month	97%	3-5 YEARS STANDARD COMMERCIAL	
3 months	92%	Terminal	
6 months	85%	F3	

PERFORMANCE DATA

Discharge Rates in **Watts** to Various End Voltages at 25°C (77°F)

Time (min)	1.85V	1.80V	1.75V	1.70V	1.67V	1.65V	1.60V
5	114	129	142	155	159	165	177
10	88.2	99.7	106	111	114	117	122
15	70.2	76.5	80.8	84.3	86.7	88.2	91.3
30	41.0	44.5	46.5	48.0	48.8	49.5	50.3
60	27.0	28.5	29.3	30.0	30.2	30.5	30.8
120	14.6	15.4	15.9	16.2	16.4	16.5	16.7
180	12.2	12.7	12.9	13.1	13.1	13.2	13.3
240	9.82	10.2	10.4	10.5	10.6	10.6	10.7
300	8.47	8.70	8.82	8.93	8.97	9.02	9.05
600	4.93	5.12	5.22	5.30	5.32	5.35	5.38
1200	2.53	2.62	2.68	2.73	2.75	2.77	2.78

Discharge Rates in **Amperes** to Various End Voltages at 25°C (77°F)

Time (min)	1.85V	1.80V	1.75V	1.70V	1.67V	1.65V	1.60V
5	70.2	82.3	90.7	96.1	98.3	101	105
10	45.8	50.4	54.6	58.8	60.5	62.4	65.6
15	37.9	41.1	43.7	46.2	47.3	48.2	49.8
30	20.8	23.2	24.7	25.6	26.2	26.9	27.7
60	14.5	15.0	15.3	15.5	15.6	15.7	15.8
120	7.65	7.96	8.08	8.19	8.22	8.26	8.31
180	6.21	6.41	6.50	6.53	6.55	6.58	6.62
240	4.97	5.07	5.14	5.20	5.22	5.25	5.28
300	4.22	4.35	4.40	4.44	4.45	4.47	4.49
600	2.48	2.56	2.60	2.61	2.62	2.63	2.64
1200	1.29	1.33	1.35	1.36	1.37	1.38	1.39

All data on the spec.sheet is an average value:

The tolerance range: $x < 6\text{min}$ (+15%~-15%), $6\text{min} \leq x < 10\text{min}$ (+12%~-12%), $10\text{min} \leq x < 60\text{min}$ (+8%~-8%), $x \geq 60\text{min}$ (+5%~-5%)

PQ12-26 12V-26AH

Lead-Acid Battery

For inquiries, orders, or technical support,
we are available 24/7 to assist you with your
battery solutions.

Phone: +44 776 981 1995

Email: info@powerq.co.uk

Website: www.powerq.com

