



POWERQ
never will be dark



PQG12-150
12V-150AH
Vrla Gel Battery



The PQG12-150 is a 12V-150Ah Vrla Gel Battery designed for solar, UPS, and backup power. It delivers reliable performance, long service life, and stable energy storage.

DIMENSIONS

Length (L)	483±3 (19.02±0.12)
Width (W)	170±3 (6.69±0.12)
Height (H)	240±3 (9.45±0.12)
Overall Height (HT)	240±3 (9.45±0.12)

Description of torque value of hardware for the terminals

Recommended torque value:

M8: 12 N·m (122 Kgf·cm)

Maximum allowable torque value:

M8: 20 N·m (204 Kgf·cm)

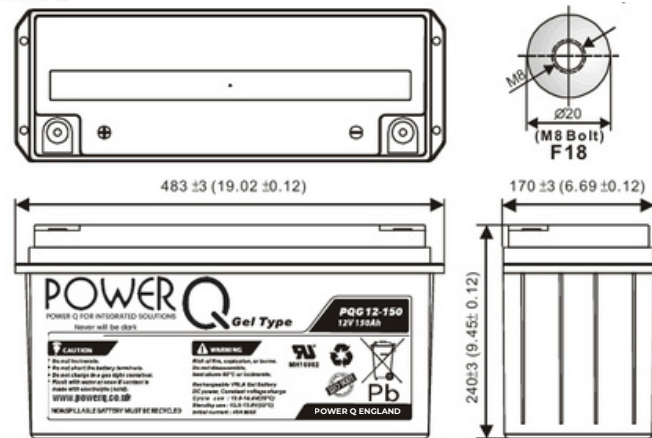

SPECIFICATIONS

(Units: mm (inch))

Nominal Voltage (V)

12v

Nominal Capacity

10 hour rate	(15A to 10.50V)	150Ah
5 hour rate	(25.5A to 10.20V)	127.5Ah
1 hour rate	(82.5A to 9.60V)	82.5Ah
1 C	(150A to 9.60V)	80Ah

Weight

Approx. 45.8kg (101 Lbs.)

Internal Resistance (at 1 KHz)

Approx. 4.7 mΩ

Maximum Discharge Current For

5 seconds: 1500A

Charging Methods at 25°C (77°F)

Cycle use:

Charging Voltage	13.8 to 14.4V
Coefficient	-5.0mV/°C/cell
Maximum Charging Current	45A

Standby use:

Float Charging Voltage	13.5 to 13.8V
Coefficient	-3.0mV/°C/cell

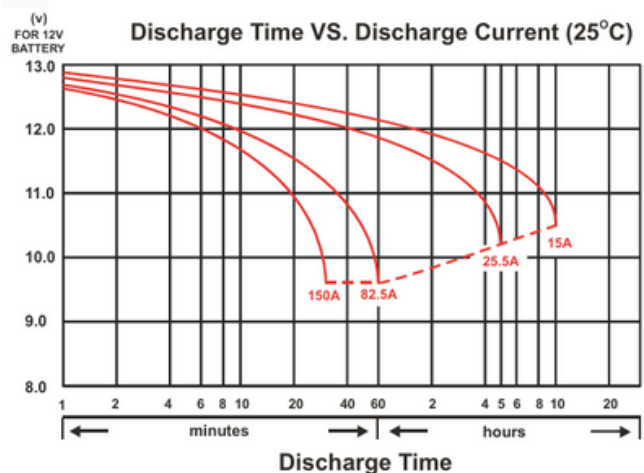

(Units: mm (inch))

Operating Temperature Range

Charge	-15°C (5°F) to	40°C (104°F)
Discharge	-15°C (5°F) to	50°C (122°F)
Storage	-15°C (5°F) to	40°C (104°F)

Charge Retention (Shelf life)

1 month	98%
3 months	94%
6 months	85%

Case Material

ABS UL94 HB
Optional: Flammability resistance of (UL94-V-0)

Design Life

EUROBAT (20°C): >12 YEARS VERY LONG LIFE

Terminal

F18

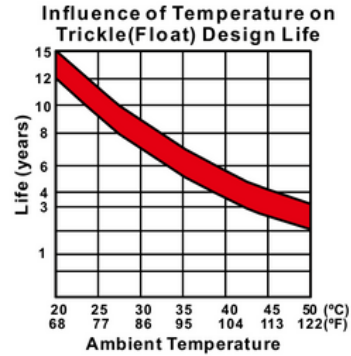
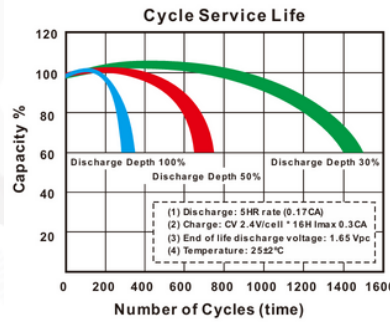
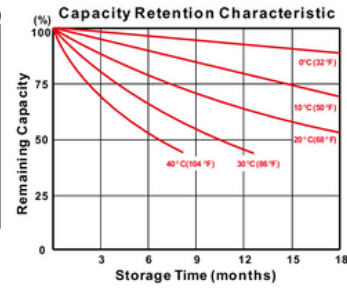
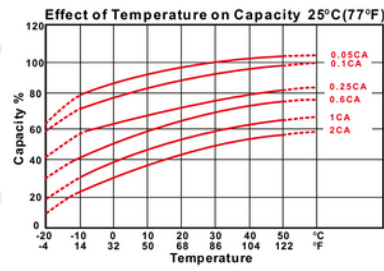

PERFORMANCE DATA

Discharge Rates in **Watts** to Various End Voltages at 25°C (77°F)

Time (min)	1.85V	1.80V	1.75V	1.70V	1.67V	1.65V	1.60V
5	497	587	680	727	777	803	810
10	407	464	520	547	576	591	601
15	349	389	427	445	464	474	485
20	313	344	372	385	399	407	418
30	249	268	284	292	300	304	314
60	156	162	165	167	169	170	178
90	128	135	137	138	139	139	141
120	103	108	110	111	112	112	113
180	72.8	76.1	77.3	78.1	78.4	78.7	79.5
240	56.9	59.5	60.3	60.9	61.3	61.4	61.9
300	45.9	47.8	48.6	49.1	49.2	49.4	49.9
480	31.2	32.5	32.9	33.3	33.4	33.6	33.7
600	29.0	30.0	30.4	30.7	30.9	30.9	31.2
1200	14.5	14.9	15.1	15.3	15.4	15.4	15.4

Discharge Rates in **Amperes** to Various End Voltages at 25°C (77°F)

Time (min)	1.85V	1.80V	1.75V	1.70V	1.67V	1.65V	1.60V
5	278	329	381	407	436	450	455
10	222	253	283	299	314	322	328
15	190	212	233	243	253	259	265
20	163	179	194	201	209	212	218
30	129	139	147	151	155	157	163
60	78.5	81.5	83.3	84.3	85.3	85.9	89.5
90	64.2	67.8	68.8	69.5	69.7	69.9	70.9
120	51.7	54.4	55.2	55.8	56.0	56.2	56.8
180	36.4	38.1	38.7	39.1	39.2	39.4	39.8
240	28.3	29.6	30.1	30.4	30.5	30.6	30.8
300	22.9	23.8	24.2	24.4	24.6	24.6	24.8
480	15.5	16.2	16.3	16.5	16.6	16.6	16.7
600	14.4	14.9	15.0	15.2	15.2	15.3	15.4
1200	7.19	7.38	7.50	7.58	7.63	7.64	7.66

All data on the spec.sheet is an average value:

The tolerance range: $x < 6\text{min}$ (+15%~-15%), $6\text{min} \leq x < 10\text{min}$ (+12%~-12%), $10\text{min} \leq x < 60\text{min}$ (+8%~-8%), $x \geq 60\text{min}$ (+5%~-5%)

PQG12-150

12V-150AH

Vrla Gel Battery



For inquiries, orders, or technical support, we are available 24/7 to assist you with your battery solutions.

Phone: +44 776 981 1995

Email: info@powerq.co.uk

Website: www.powerq.com

